

3. After the Treatment:

- Discard the medicine cup
- Empty the water chamber
- Clean the nose mask (can be sterilised and autoclaved)
- Disassemble the chamber itself and wipe off any medicine remnants

IMPORTANT: Due to the advanced electronics, the handle and the bottom of this device must be cleaned with a damp cloth or sponge. Never immerse the appliance in water or keep it under running water.

4. Battery

- The battery is indicated with the yellow/orange light emitting diode on the back of the device. When the battery requires a recharge, the light emitting diode will light up intermittently (Fig. 4.1). The signals will speed up as the battery power gets lower.
- Nequilizer contains 6 rechargeable batteries which will last 5-10 treatments before any recharging is required.
- The Nequilizer is supplied with a charger. The recharging process will be indicated by a constant emission of light from the yellow/orange diode at the back of the appliance. Once the battery is fully charged, the yellow/orange light emitting diode will light up intermittently. The appliance does not function as long as it is connected to the charger.
- A charger for the car can be purchased separately.

5. Water Chamber

- The red light emitting diode on the back of the apparatus indicates the water level of the lower water chamber and it will light up if the level is too low. The atomisation process will cease immediately (Fig. 5.1).
- Refill with tap water until the marker is reached (Fig. 5.1) and subsequently continue the treatment.

6. Fault Finding – Failing Atomisation

The device can be switched on and started up, but no medicine vapour is visible:

- Check for water in the water chamber. If, for some reason, the water is not conductive (for clean water), the atomisation process will not take place. In this instance, a few grains of salt can be added to the water in the water chamber to make it conductive. The process will work optimally if the water in the water chamber is at room temperature.
- Check whether there is any medicine in the medicine cup and that the medicine cup is unused, intact and without holes or indentations.
- Check whether the fan at the top of the atomiser is functioning during the atomisation process. If not, the fan can be moved manually to help it get started. If the fan fails to start, the device is classed as faulty – please use the below-mentioned details to contact Equine Nebulizer.

If the battery indicator lights up:

- The yellow/orange light will come on if the device needs recharging
- No response from the device at all – try to recharge it – the device might have been run down completely.

If the device still fails to function correctly please send it to the manufacturer for repair.

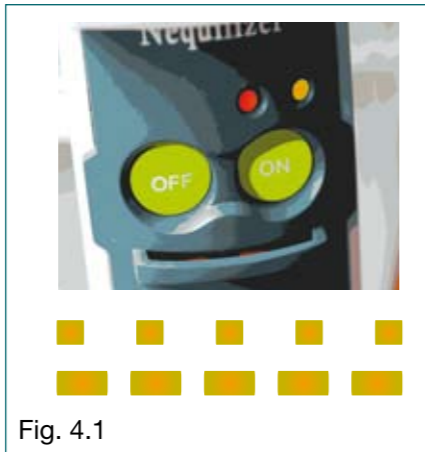

Fig. 4.1

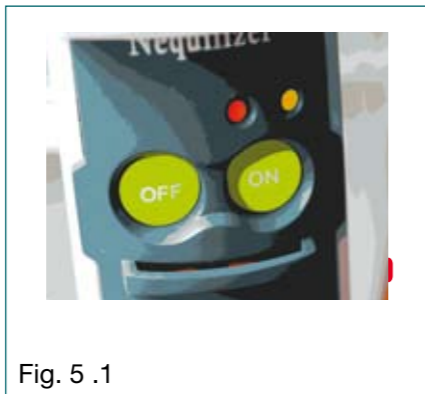

Fig. 5.1



Fig. 5.2

7. Storage

- The Nequilizer must be stored in a dry, frost-free place in its original plastic packaging material.
- The medicine is to be stored according to the directions on the back of the medicine container at all times – usually at room temperature.

8. Device Functionality During Treatment

- Atomisation starts immediately upon pressing the ON button (Fig. 8.1)
- If respiration stops, the atomisation process will cease after 25 seconds upon which the chamber is full (Fig. 8.2) – ie. the maximum amount of medicine which can possibly be atomised in the chamber has been achieved. The fact that the process stops results in minimal loss of medicine in the form of condensed and deposited medicine on walls etc.
- Upon registering a breath, the device will automatically calculate the remaining amount of medicine in the chamber and adjust the atomisation process accordingly, ie. the atomisation process will last for the number of seconds that is required to completely fill up the chamber again. Respirations may vary from horse to horse and consequently, the atomisation process will not necessarily last the full 25 seconds following each breath. Atomisation will not be instigated until a new breath has been registered.
- As the treatment draws to an end, the density of the atomised medicine will lessen.

Approx. ½ ml of medicine, which has not been through the atomisation process, will remain in the medicine cup after each session.

9. How to Use the Nequilizer on the Horse

The Nequilizer is designed to fill up the chamber following each inhalation and it can be applied in two ways:

- The device can either be left on the nostril of the horse for the entire duration of the treatment or it can be removed whilst the chamber refills and subsequently be reapplied to the nostril of the horse (Fig. 9.1).
- Allow the horse to inhale once or twice in order to empty the chamber. The free nostril can be covered during inhalation to promote intake of the medicine in the chamber.
- Keep the device permanently on the nostril of the horse until finalisation of treatment. If you use the device this way, the atomisation process will run constantly.

Please note that the horse cannot exhale via the device. Consequently, ensure that the horse can exhale freely through the unused nostril – this is of particular importance if the free nostril has been covered to promote inhalation of the medicine, see item 1.

In case you have any queries regarding the use of the Nequilizer please check the website: www.nequilizer.com

or contact:

Manufacturer's ID:
Equine Nebulizer
Stumpedyssevej 26
2970 Horsholm
Denmark
+45 48 20 59 00
e-mail: info@equinehaler.com
CE marking: Bo

Jørgen Kruuse A/S
Havretoften 4
DK-5550 Langeskov
Tlf.: (+45) 72 14 15 16
Fax: (+45) 72 14 15 00
info@kruuse.com

Kruuse Svenska AB
Bagartorpsringen 51
S-170 08 Solna
Tlf.: (+46) 08-850200
Fax: (+46) 08-857517
kruuse.svenska@kruuse.com

Kruuse Norge AS
Dyrløkkeveien 19
N-1440 Drøbak
Tlf.: (+47) 64 90 75 00
Fax: (+47) 64 90 75 01
kruuse.norge@kruuse.com

Kruuse UK Ltd.
12 Sherburn Network Centre,
Lancaster Close, Sherburn In Elmet,
North Yorkshire, LS25 6NS.
Tel: +44 (0) 1977 681523
Fax: +44 (0) 1977 683537
kruuse.uk@kruuse.com



Fig. 8.1



Fig. 8.2

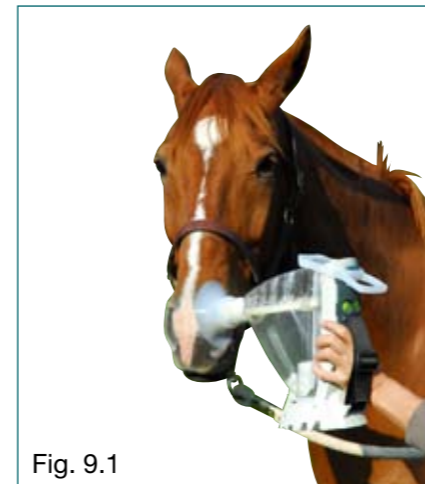

Fig. 9.1



Equine Nequilizer Instruction Manual



Equine Nequilizer consists of:

- Battery and water level (water chamber) indicators
- ON/OFF buttons
- Rubber band

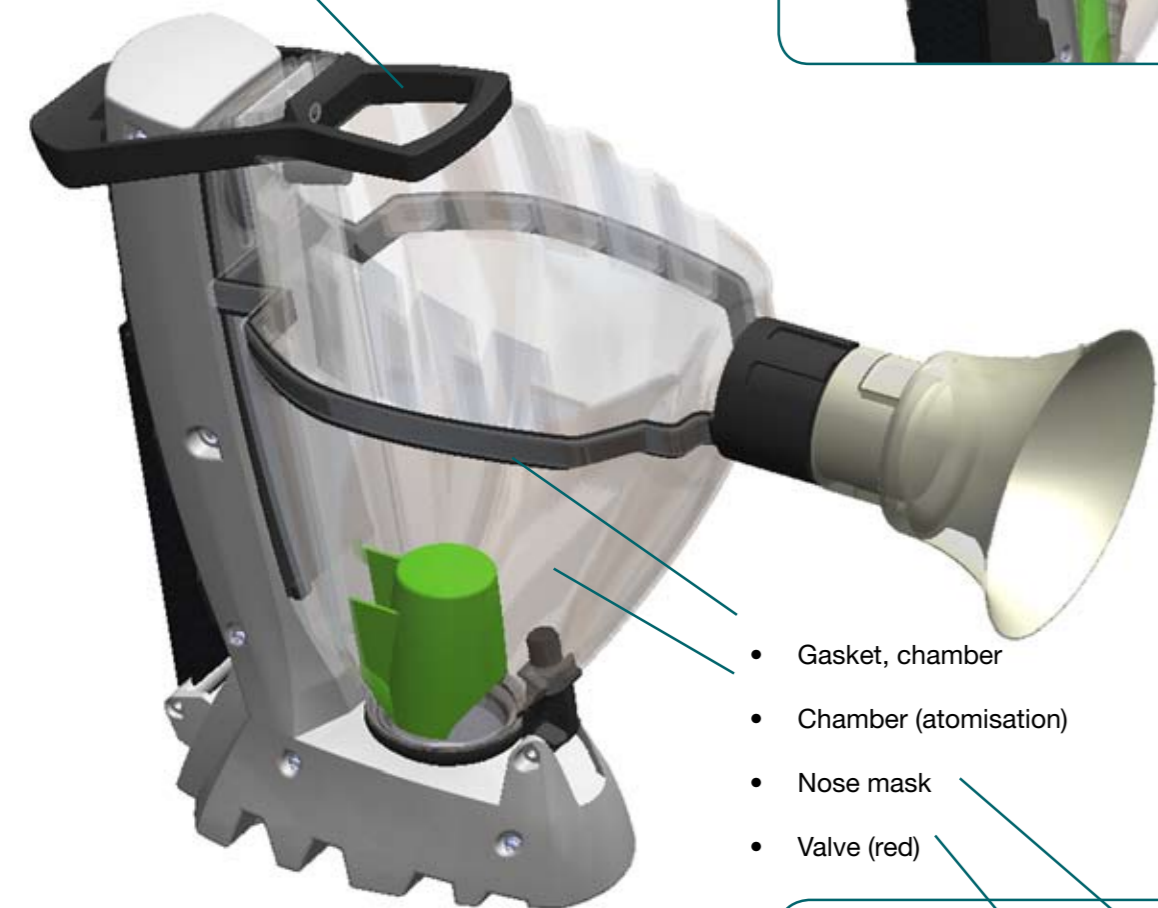
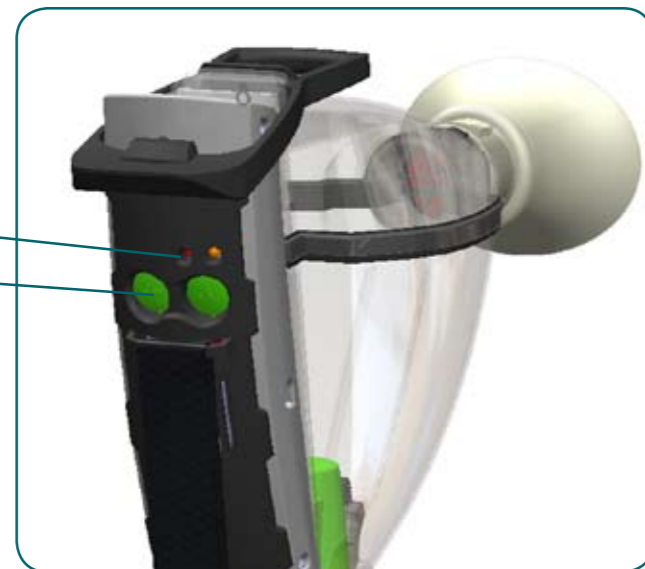

- Gasket, chamber
- Chamber (atomisation)
- Nose mask
- Valve (red)

- Medicine cup
- Seal, water chamber
- Water chamber

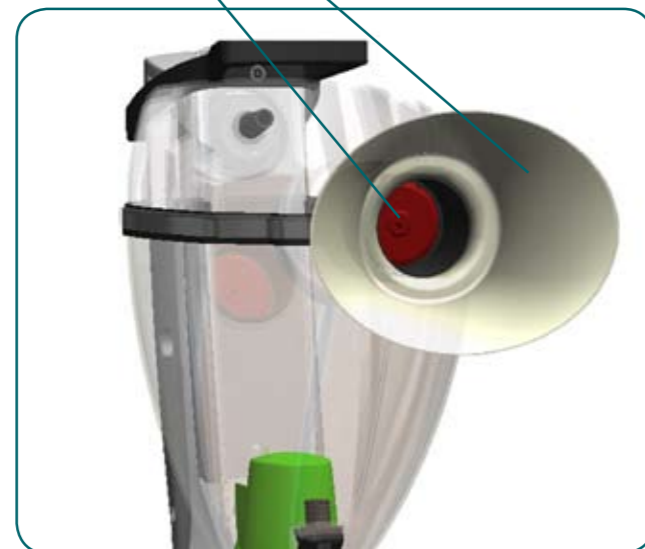
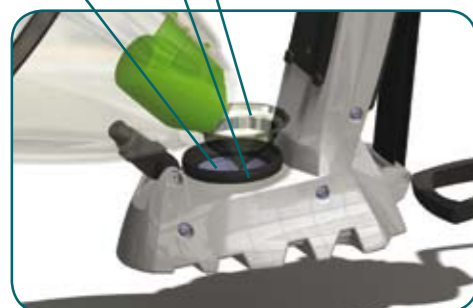

Equine Nequilizer Instruction Manual

The Nequilizer is an atomiser, which is based on ultrasound technique, and consequently, it can only be used with water-based types of medicine. Use of oil-based medicine in atomisers based on ultrasound technology should be avoided at all times.

1. Preparation – atomisation:

- Remove the rubber band and allow the chamber to tilt forward (Fig. 1.1)
- Fill up the lower water chamber (situated underneath the medicine cup) with tap water (Fig. 1.2)
- The water must reach the marker inside the water chamber to ensure correct atomisation. Subsequently, put in an unused medicine cup on top of the loose rubber seal (Fig. 1.3)
- Fill up the medicine cup with the medicine as prescribed by your vet or according to the instructions on the back of the medicine container (Fig. 1.4)
- The medicine cup must be discarded after each use. Failure to exchanging the medicine cup will lead to calcium sediment deposits and indentations in the medicine cup which may result in reduced or no atomisation
- Tilt the chamber back in place and close it with the rubber band (Fig. 1.5)
- The Nequilizer is now ready for use

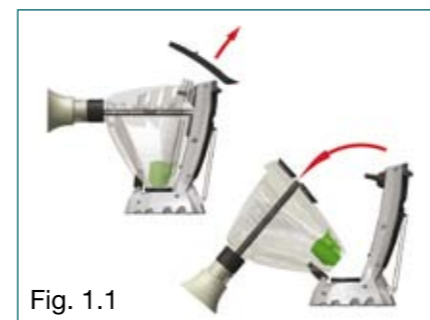

Fig. 1.1



Fig. 1.2



Fig. 1.3



Fig. 1.4



Fig. 1.5

IMPORTANT: Always keep you hand positioned between the strap and the handle at the back of the device to avoid dropping it during preparation or treatment. Electronics contained in this device will suffer from being dropped on the floor.



2. Operation:

Press the "ON" button to start the atomisation process (Fig. 2.1). Atomisation will set in immediately upon pressing the "ON" button.

- A light source inside the chamber will emit constant lighting to indicate that atomisation is in progress (Fig. 2.2). You will notice the actual atomisation process of the medicine as a fog that rises to the top. The valve within the nose mask prevents the medicine from being released into open air and ensures that it stays in the chamber until the horse inhales. At the same time, the valve works as a blocking device in case the horse should exhale into the chamber. If the medicine vapour is not visible in the chamber – this indicates that something is wrong. Stop the treatment process until the fault has been found.

See the fault finding section.

- The atomisation process runs for approx. 25 seconds and fills up the chamber with particles
- Whilst the chamber fills up with medicine the ventilator at the top of the device ensures an even distribution of the medicine in the chamber
- After approx. 25 seconds, the atomisation process stops until the horse has inhaled (Fig. 2.3) and thereby activated the atomiser. If atomisation is not in progress, intermittent light can be seen in the chamber (Fig. 2.2). When atomisation is reactivated by the horse's breathing, the light will again switch to constant.
- If the horse fails to activate the atomisation process for more than two minutes, the device will automatically switch off – same as pressing the "OFF" button. To reactivate the atomisation process, you must press the "ON" button again, whereupon atomisation will commence for 25 seconds (Fig. 2.1).
- Calculations of the amount of the medicine in the chamber are carried out continuously. If a certain amount of medicine remains in the chamber following inhalation, the subsequent duration of the atomisation will be adjusted accordingly in order to avoid that an excess amount of medicine will cause unwanted congestion within the chamber.
- It will take approx. 4-5 minutes to atomise 5 ml or the equivalent of approx. 15 respirations providing the fact that the chamber is filled up completely between each inhalation. Under normal circumstances approx. 0.5 ml will be left behind in the medicine cup.



Fig. 2.1



Fig. 2.2



Fig. 2.3